

**These are the notes referred to on the following official copy**

The electronic official copy of the title plan follows this message.

Please note that this is the only official copy we will issue. We will not issue a paper official copy.

This official copy was delivered electronically and when printed will not be to scale. You can obtain a paper official copy by ordering one from HM Land Registry.

This official copy is issued on 06 June 2023 shows the state of this title plan on 06 June 2023 at 14:27:38. It is admissible in evidence to the same extent as the original (s.67 Land Registration Act 2002). This title plan shows the general position, not the exact line, of the boundaries. It may be subject to distortions in scale. Measurements scaled from this plan may not match measurements between the same points on the ground. This title is dealt with by the HM Land Registry, Nottingham Office .

© Crown copyright. Produced by HM Land Registry. Reproduction in whole or in part is prohibited without the prior written permission of Ordnance Survey. Licence Number 100026316.

# H.M. LAND REGISTRY

TITLE NUMBER

## NT2240

ORDNANCE SURVEY  
PLAN REFERENCE

COUNTY SHEET  
NOTTINGHAMSHIRE

NATIONAL GRID  
SK 5942

SECTION  
M

Scale: 1/1250

GEDLING DISTRICT

© Crown Copyright 1970

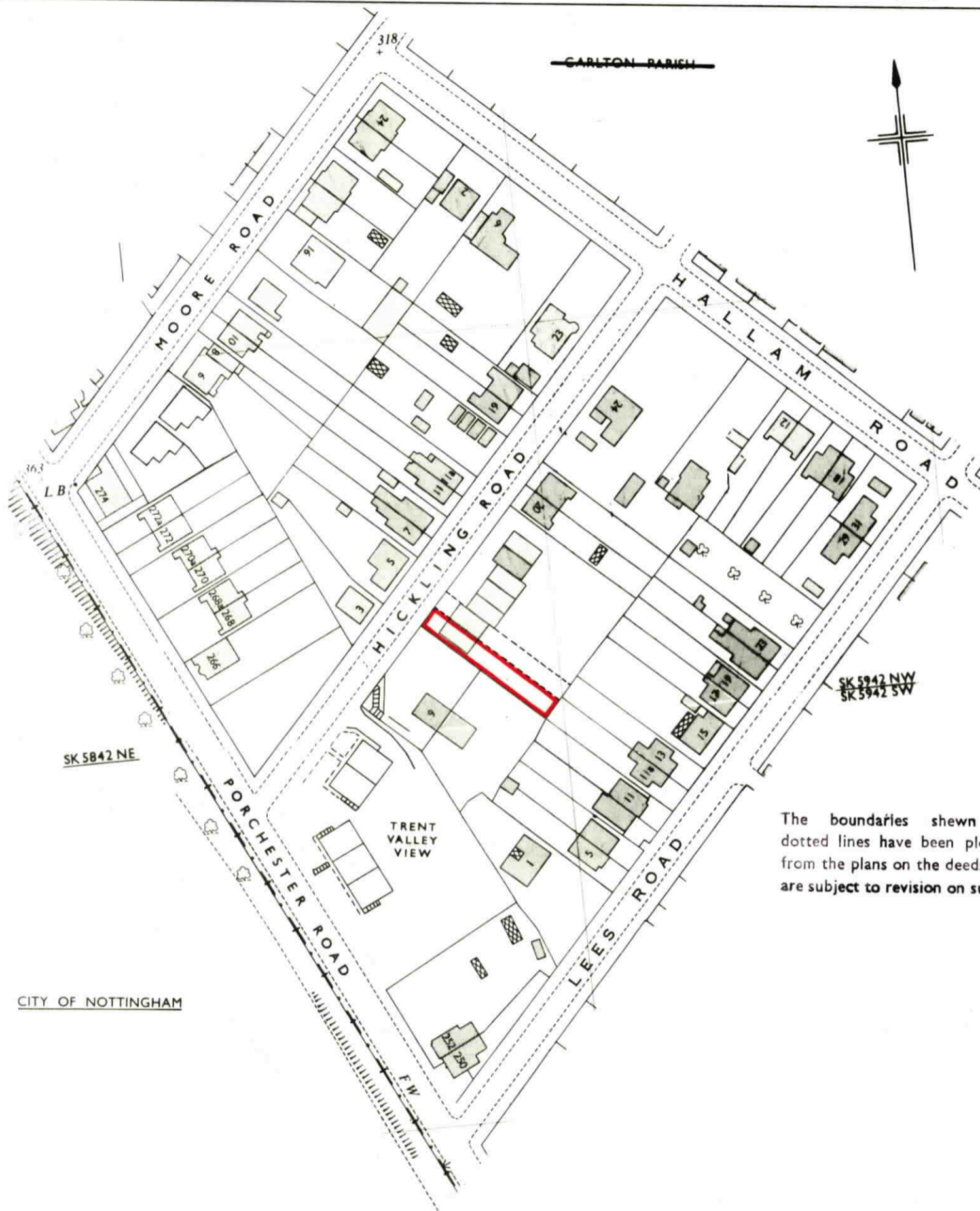

The boundaries shewn by dotted lines have been plotted from the plans on the deeds and are subject to revision on survey



17.